



# Technical Data Sheet.

## CLA-NA. Compression Load Cells. (500N to 20kN Capacity).



The CLA-NA Load Cell is a compact load cell with capacities ranging from 500N up to 20kN. It can be used for measuring compressive forces in industrial assembly and testing machines.

### Physical Dimensions

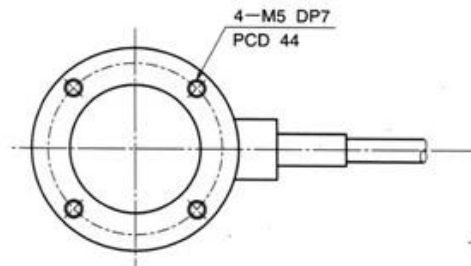
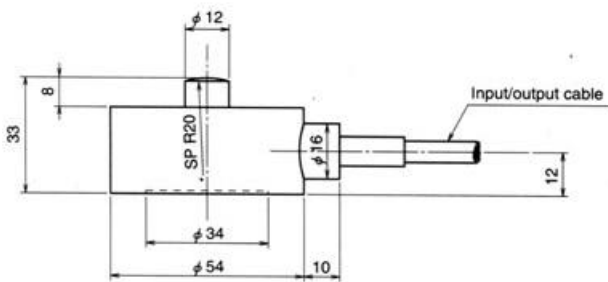

### Specifications.

Type	CLA-500N	CLA-1kN	CLA-2kN	CLA-5kN	CLA-10kN	CLA-20kN
Capacity	500N	1kN	2kN	5kN	10kN	20kN
Rated Output	1.5mV/V +/-0.5%					
Non-linearity	0.2%RO					
Hysteresis	0.1%RO					
Temperature Effect on Zero	0.01%RO/°C(0~+40°C)					
Temperature Effect on Span	0.01%/°C(0~+40°C)					
Temperature Range Allowable	-10~+60°C					
Over Load	150%					
Resistance	350Ω+/-2%					
Exciting Voltage Recommended	Less than 6V					
Exciting Voltage Allowable	15V					
Initial Unbalance	5%RO					
Electrical Connection	Ø6mm 0.35mm <sup>2</sup> 4-core Shielded Chloroprene Cable 5m					
Weight	0.36Kg					